

# RedKite

IMPORTANT!  
KEEP FOR FUTURE REFERENCE.

Read these instructions carefully before use.

Your child may be hurt if you do not follow the instructions. Adult assembly required.

Instruction Leaflet

Cozy Bounce



Suitable for babies from birth.

WARNING: Not recommended for children who can sit up by themselves  
(6 months approximately, until 9kg). Adult assembly required.

Complies with: BSEN 12790 - 2009. Customer Care Line: 01454 326 568

## Parts list

1. Backrest frame
2. Rear connector tube
3. Right support frame
4. Left & right plastic connector
5. Music box
6. 13mm screw
7. Footrest frame
8. Left support frame
9. Seat pad
10. Toy bar and toys

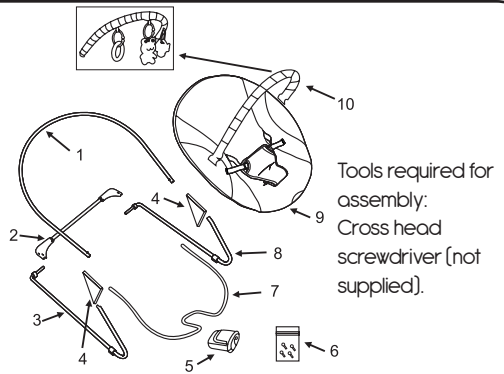

## Assembly instructions

1. Check that all parts are present before assembly.
2. Place the left and right support frames opposite each other, with the rear connector tube between them on a flat surface (1).
3. Lift the flip clip on both sides of the rear connector tube, lift the left support frame and right support frame into the rear frame tube. Close the flip clip over the tube and press down until the flip clip locks in place (2,3).

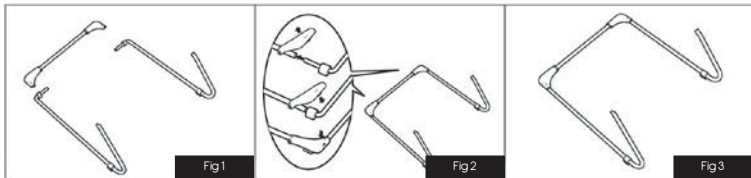

4. Fit left plastic connector to the left support frame and attach screws. Repeat procedure to fit the right plastic connector and the right support frame (4,5).
5. Fit both ends of the footrest frame together and attach screws (6).

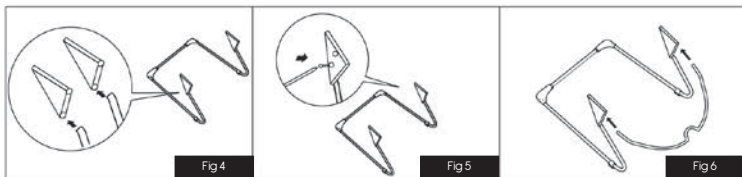

6. Fit both ends of the backrest frame by holding down the spring loaded pin. Push the frames until the pin locates into the holes (7).
7. Open the pocket at the rear of the seat cover back. Slide over the seat backrest and stretch the bottom of the seat cover over the footrest frame (8).

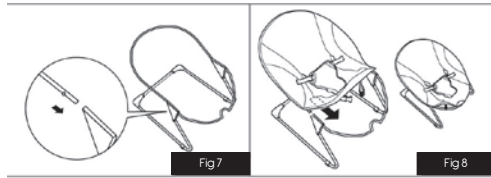

8. Slide the top of the music box through the hole in the seat cover and onto the footrest frame. Reverse the procedure above to remove the music box and attach the clips under the seat (9,10). Ensure the music box has been placed in the box the correct way up.

9. Clip the toy bar to each side of the bouncer frame (11). Pull the lip to remove the toy bar .

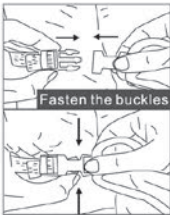
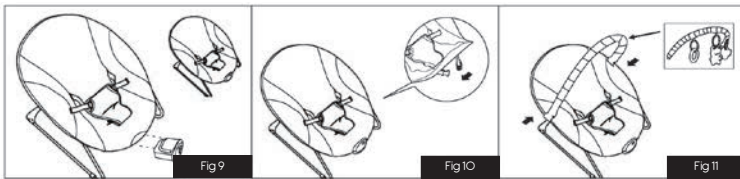

### Adjusting and securing the harness

Place baby in the bouncer with the crotch strap positioned between his / her legs. Fasten the buckles on both sides of the restraint, pressing until you hear a 'click'. Adjust the sliders on both straps to achieve a snug but comfortable fit. To release, press the clips on the buckles and remove the harness straps.

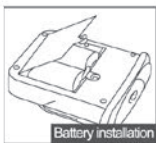

### Battery Installation

Use a small Phillips head screwdriver to open the battery compartment door on the vibration unit. Insert the battery as indicated inside the battery door and replace the screw. The vibration unit requires 2 "C" batteries.

CAUTION - The harness should be worn and correctly adjusted at all times.  
 CAUTION - Do not make any adjustments when the child is in the reclined cradle.  
 CAUTION - The toy bar is NOT a handle. Never attempt to carry the reclined cradle by the toy bar.

## General Care:

- The correct use and maintenance of this reclined cradle is essential.
- In some climates mould and mildew can affect the fabric on the reclined cradle.
- Always store the reclined cradle in a dry place.
- This reclined cradle does not replace a cot or a bed. Should your child need to sleep, then it should be placed in a suitable cot or bed.
- Please dispose of packaging material as plastic bags can be dangerous to young children.

## Cleaning:

- The cover may be sponge cleaned in situ using a mild detergent solution.
- For heavy soiling the cover may be removed and hand washed using a mild detergent solution.
- Lie cover flat and dry in a well ventilated area out of direct sunlight.
- Do not use bleach, ammonia based or abrasive cleaning chemicals.
- Do not dry clean.
- The frame and plastics may be cleaned with a damp cloth and a mild detergent solution and dried with a soft cloth.

## Maintenance:

- Regularly inspect all tubes and fixings. Ensure that all are secure before each use of the product.
- Do not use the reclined cradle if any components are broken or missing.
- Regularly inspect fabric and stitching and check that it is undamaged.
- Do not use accessories or replacement parts other than those approved by the manufacturer. Failure to do this may invalidate your warranty.

## Safety Warnings:

- **WARNING:** Your child's safety is your responsibility.
- **WARNING:** Do not use the reclined cradle once your child can sit unaided.
- **WARNING:** Never leave the child unattended.
- **WARNING:** This reclined cradle is not intended for prolonged periods of sleeping.
- **WARNING:** It is dangerous to put this cradle on an elevated surface, e.g. a table.
- **WARNING:** Always use the restraint system.
- **WARNING:** Never use the toy bar to carry the reclined cradle.

- Always ensure that the harness is fastened and adjusted at all times.
- Only use on a flat, level floor surface.
- Do not use near stairs / steps.
- Do not position the reclined cradle close to a source of heat e.g. household electric fires etc.
- Do not position close to items such as curtains and electrical flexes as they could pose a danger of suffocation or strangulation.
- Never use in a vehicle as a child restraint.
- Never pick the reclined cradle up when the child is in it.
- Do not adjust the reclined cradle when the child is in it.
- Store the reclined cradle out of the reach of children when not in use.
- Do not allow other children to play with the reclined cradle.
- **Battery Safety**
- Always keep batteries and tools out of reach of babies and children.
- Always remove spent batteries from the toy to avoid the danger of leakage from the battery which can be dangerous and damage the product.
- Remove the batteries if the toy will not be used for a long period of time.
- Only use alkaline batteries of the same type or equivalent to the type recommended for the correct function of this product.
- Never mix new and old or different types of batteries.
- When fitting new batteries, always ensure that they have been fitted in the correct polarity (as shown on the product).
- Do not burn or dispose of spent batteries into the environment. Dispose of them at an appropriate differentiated collection point.
- Do not short circuit the battery terminals.
- Never attempt to recharge non-rechargeable batteries, they might explode.

The product complies with  
BS EN 12790 : 2009.

Imported by The Red Kite Baby Co Ltd. , 35  
Lavenham Road, Beeches Industrial Estate, Yate,  
Bristol, BS37 5QX.